

## CX-ED1579L 'All In One' Fire Rated Electric Strike



**CX-ED1579L Grade 1 fire rated 'all in one' electric strike offers 'Universal' performance with six stainless steel faceplates, field selectable voltage, fail safe/fail secure operation, and latch bolt monitor included.**

**CX-ED1579L is UL security and 3-hour fire rated, non-handed, and compatible with most mortise and cylindrical locksets. In addition, it features adjustable latch monitor placement and easy-fit wiring connectors for power and monitoring.**



EXCLUSIVE  
PRODUCTS



BEST QUALITY

### Features

- For mortise and cylindrical locksets
- 3/4" (19mm) latch projection (throw)
- 6 stainless steel faceplates included
- Faceplates also available in black architectural finish (BHMA 622, US19)
- Selectable fail safe/fail secure operation
- Selectable 12/24V AC/DC
- Built-in latch monitoring
- Non-handed, LH/LR
- Easy fit connectors for power and monitoring wires
- Stainless steel strike body
- 5 year warranty
- ANSI/BHMA A156.31, Grade 1 certified



## SPECIFICATIONS

Voltage:	12/24V AC/DC
Current Draw:	260mA @12V AC/DC 150mA @24V AC/DC
Static Strength:	1,500 lbs.
Dynamic Strength:	70 ft-lbs.
Mode:	Field Selectable Fail Safe or Fail Secure
Operation:	AC Buzz, DC Silent
Duty:	Continuous (DC)
Mounting:	Non-handed
Endurance:	1,500,000 Cycles (Factory Tested)  500,000 Cycles (UL Verified)
Fire Rating:	UL10C/CAN4-S104 3hrs. (Fail Secure Mode Only)
Latch Bolt Monitor:	SPDT, 100mA @ 24V DC
Dimensions:	4-7/8"H x 1-5/8"W x 1-3/4"D (124mm x 41mm x 45mm)

## DIMENSIONS

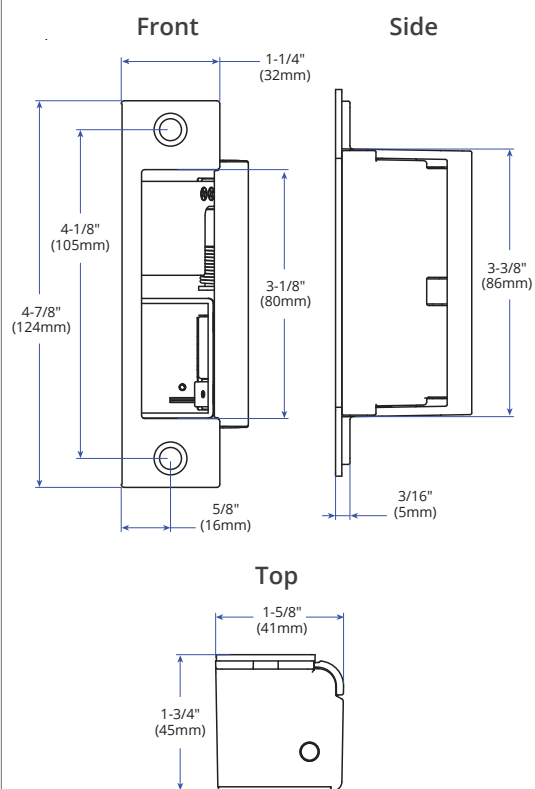

## ORDERING INFORMATION

### MODEL

#### CX-ED1579L

Grade 1 'All in One' fire rated strike, 12/24V AC/DC, For mortise and cylindrical locksets.  
Includes stainless steel faceplates: CX-EMP-1, CX-EMP-2, CX-EMP-3, CX-EMP-4, CX-EMP-5, CX-EMP-6

#### CX-ED1579L-BK

Grade 1 'all in one' fire rated strike, 12/24V AC/DC, For mortise and cylindrical locksets.  
Includes black stainless steel faceplates: CX-EMP-1-BK, CX-EMP-2-BK, CX-EMP-3-BK, CX-EMP-4-BK, CX-EMP-5-BK, CX-EMP-6-BK

## FACEPLATES (INCLUDED IN PACKAGE, AVAILABLE IN BLACK)

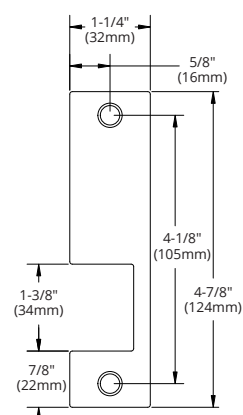

**CX-EMP-1:**  
For Sargent, Schlage  
and Yale mortise  
locksets

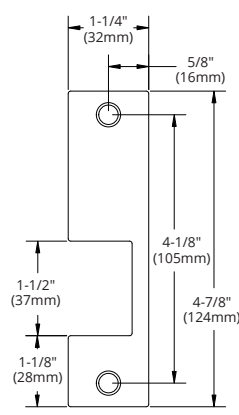

**CX-EMP-2:**  
For Arrow, Corbin and  
Best mortise locksets

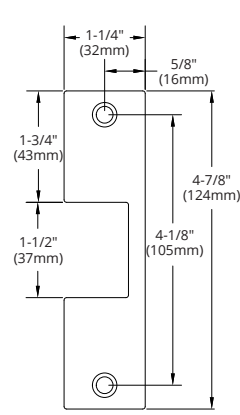

**CX-EMP-3:**  
For centerline mortise  
or cylindrical locksets

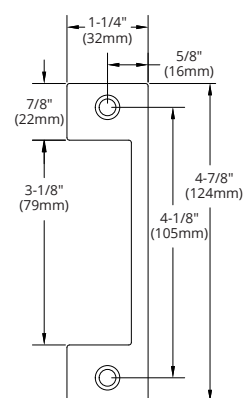

**CX-EMP-4:**  
For Sargent, Schlage  
and Yale mortise  
locksets

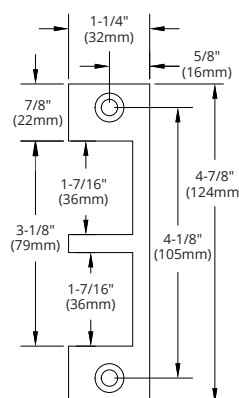

**CX-EMP-5:**  
For Arrow, Corbin and  
Best mortise  
locksets

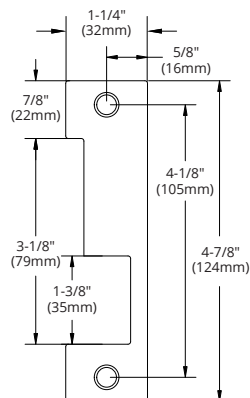

**CX-EMP-6:**  
For Sargent 8100/7700,  
Schlage and Yale  
mortise locksets



Opening New Doors to Innovation, Quality, and Support!

2395 Skymark Ave, Mississauga, ON Canada L4W 4Y6 • Toll Free: 1(877) 226-3369 (CAMDEN9)

Tel: (905) 366-3377 | Fax: (905) 366-3378 | E-mail: info@camdencontrols.com | www.camdencontrols.com



FS 541752

Part #: MKTG-LIT-SP-CX-ED1579L\_R4